

# 1.Standard Kit Combination (C-PMSB)

## Accessories

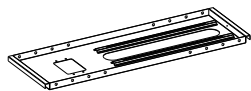

Ceiling Mount x1  
(for soft ceiling hoisting)

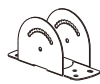

Boom Positioning Block x1  
(for fixed hoisting)

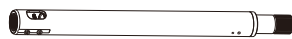

Boom x1  
(Extendable length: 600-1000mm)

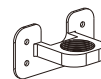

Boom Connector x1



Decorative Plate x1



Nut x1



Wire Rope Kit 2mm\*3.3m x4  
For ceiling load-bearing



M6\*60x3  
For fixing Boom attachments



M6\*16x4  
For fixing Boom attachments



M5\*16PW x2  
For fixing Boom Positioning Block



M3\*12 x2  
For fixing Ceiling Mounts



M4\*12 x2

## Bracket Exploded View

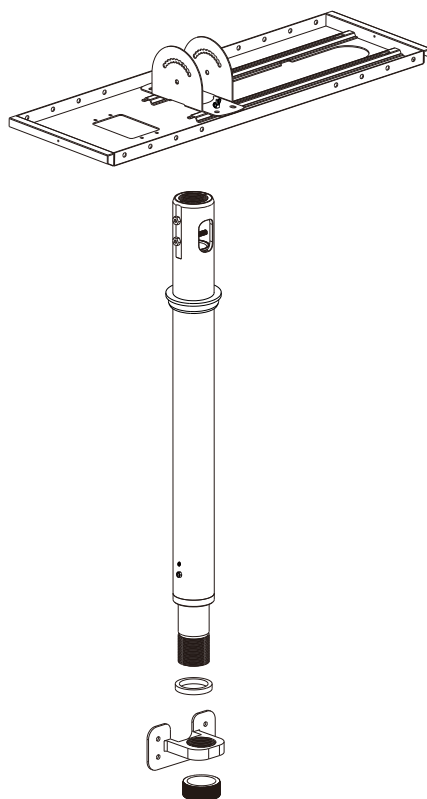

## Installation Steps

①

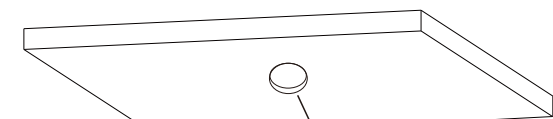

Plasterboard

Make a through hole with a diameter of 55mm according to the actual position.

②

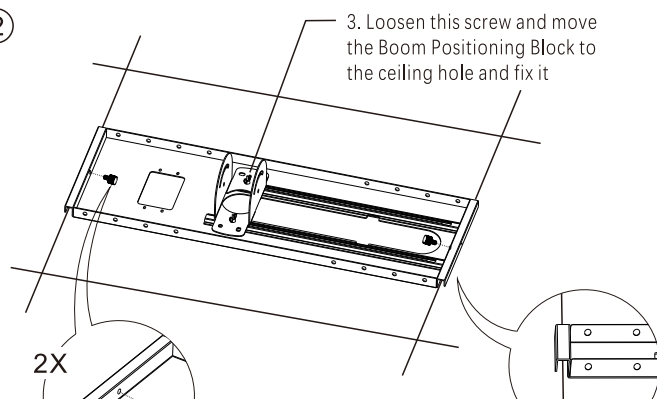

3. Loosen this screw and move the Boom Positioning Block to the ceiling hole and fix it

2X

2. Use M3\*12 screws to fix both ends of the Ceiling Mount.

1. Place the Ceiling Mount on the Plasterboard and hook the keel.

③

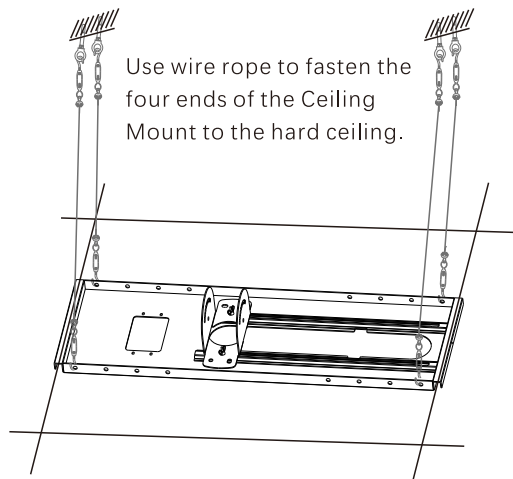

④

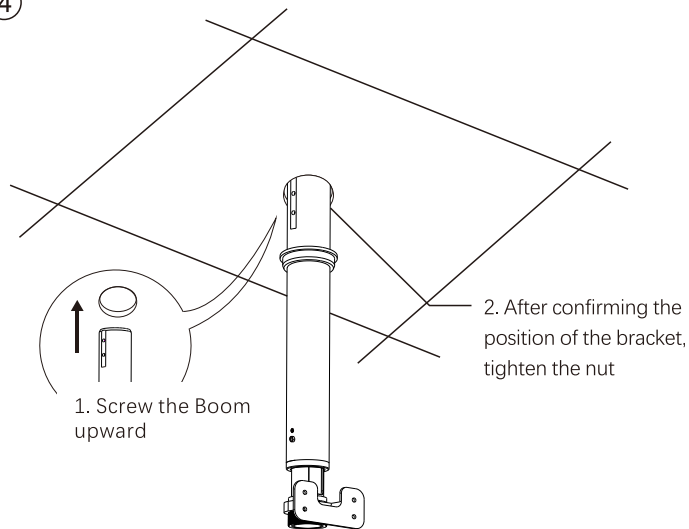

⑤

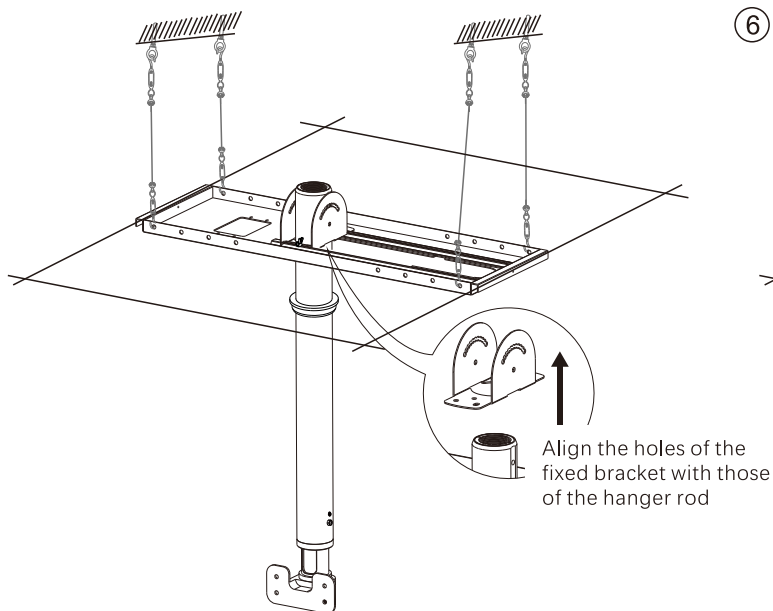

⑥

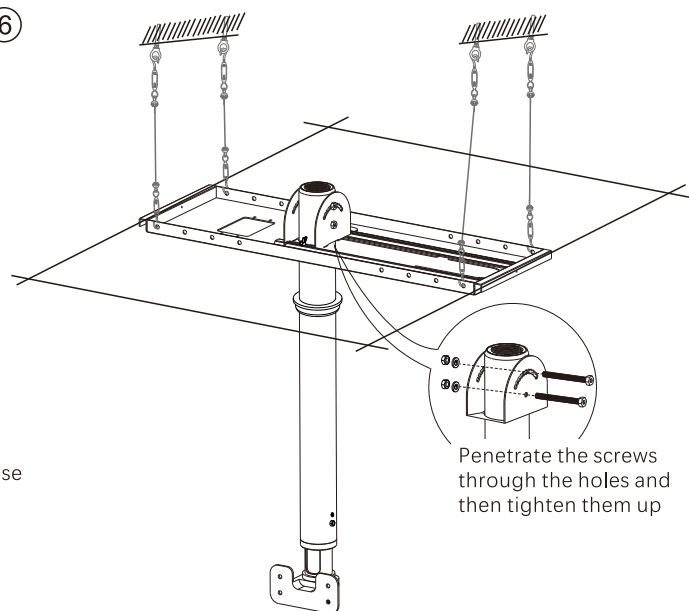

⑦

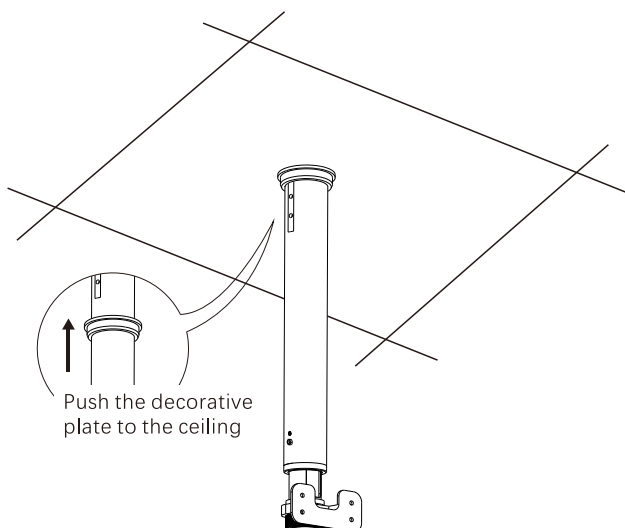

# Ceiling Bracket - Combination A

## Accessories

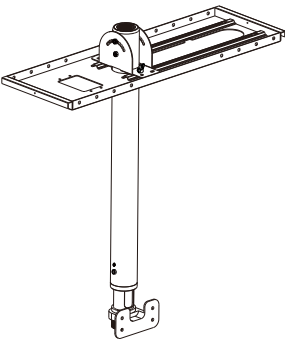

Standard Kit Combination  
(C-PMSB)



Small bracket

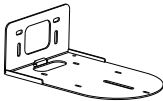

C-WM1B x1  
Small bracket



M3\*6PW x3  
Included with Camera purchased

Medium Bracket

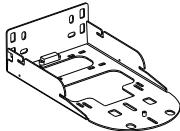

C-WM2B x1  
Medium Bracket



M3\*6PW x3  
Included with  
Camera purchased



M4\*8PW x3  
Included with  
Camera purchased



Fixing Screw  
(1/4-20UNC) x1  
Included with  
Camera purchased

Large bracket

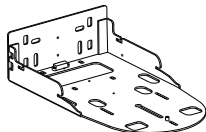

C-WM3B x1  
Large bracket



M4\*8PW x3  
Included with Camera purchased



Fixing Screw  
(1/4-20UNC) x1  
Included with Camera purchased

< Note: According to the series of the camera, select the corresponding bracket correctly >

## Bracket Exploded View

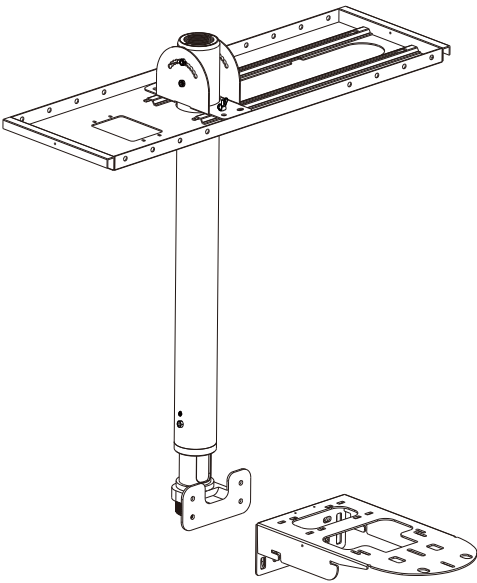

## Standard Installation Steps

①

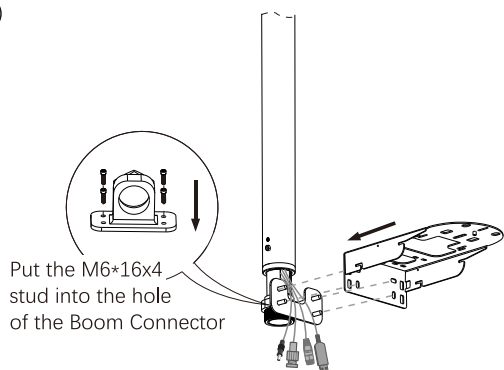

②

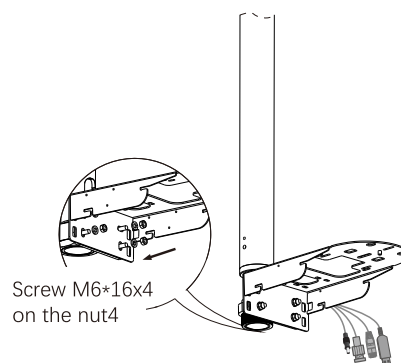

③

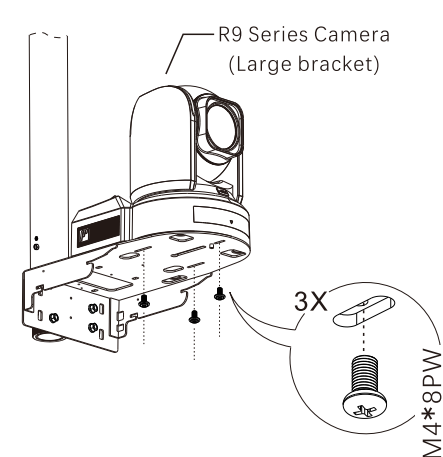
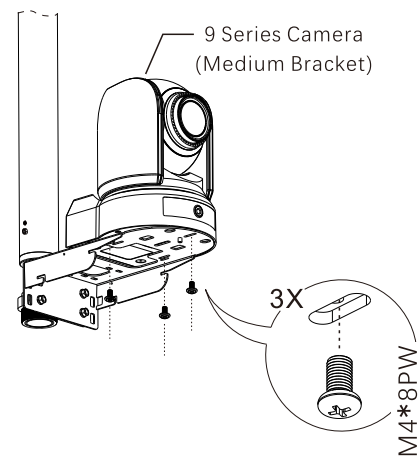
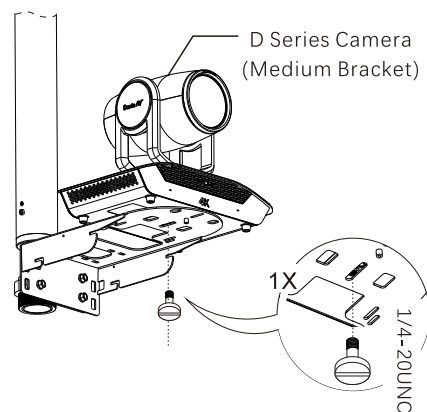
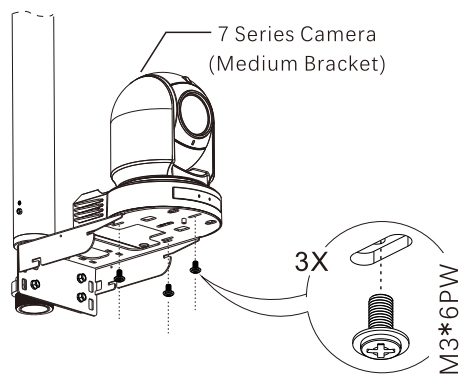
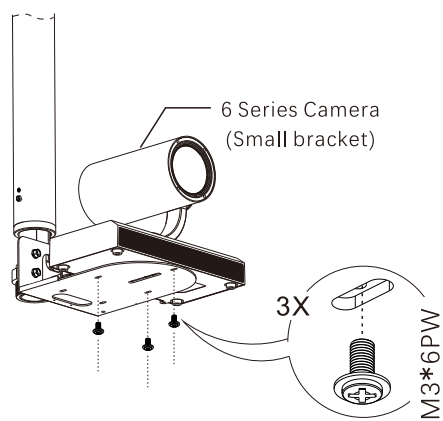
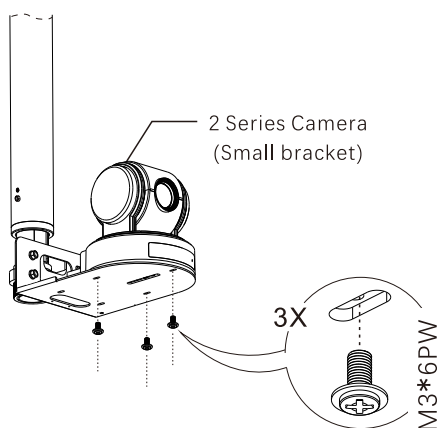



# Ceiling Bracket - Combination B

## Accessories

Standard Kit Combination  
(C-PMSB)

Medium Bracket

C-WM2Bx1  
Suitable for 7、D series

C-WM2B-CV  
Decorative Cover x1 - optional

1/4-20UNC x1  
Included with Bracket Purchased

M3\*6PW x3  
For fixing 7 series cameras

M3\*6 x3  
For fixing Decorative Cover

Cable Ties x 2  
For securing cables and power adapter

Large Bracket

C-WM3Bx1  
Suitable for B9、R9 series

C-WM3B-CV  
Decorative Cover x1 - optional

1/4-20UNC x1  
Included with Bracket Purchased

M4\*8PW x3  
For fixing B9/R9 series cameras

M3\*6 x3  
For fixing Decorative Cover

Cable Ties x 2  
For securing cables and power adapter

## Bracket Exploded View

## Decorative Cover Installation Steps (Continue with Standard Installation)

①

Tie the wire onto the bracket

②

1.Align the installation position according to the arrow mark, and snap the lower cover into place.  
2.Push Leftward

5/9

③

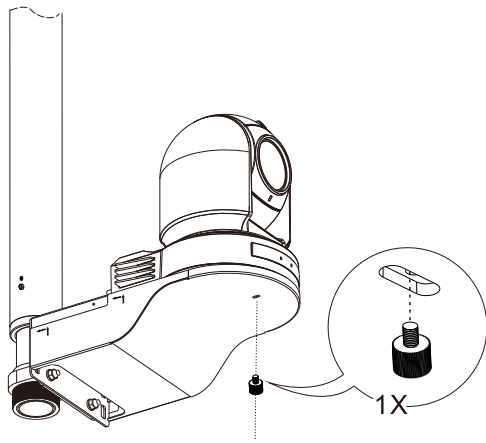

④

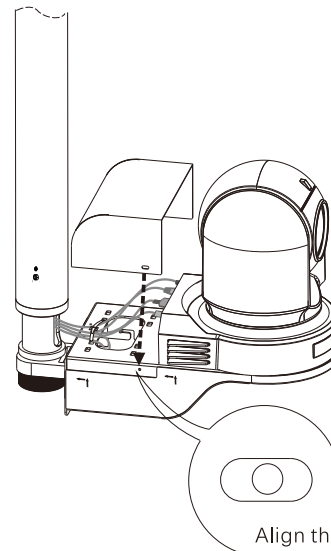

Align the Decorative cover A positioning holes with the bracket screw holes.

⑤

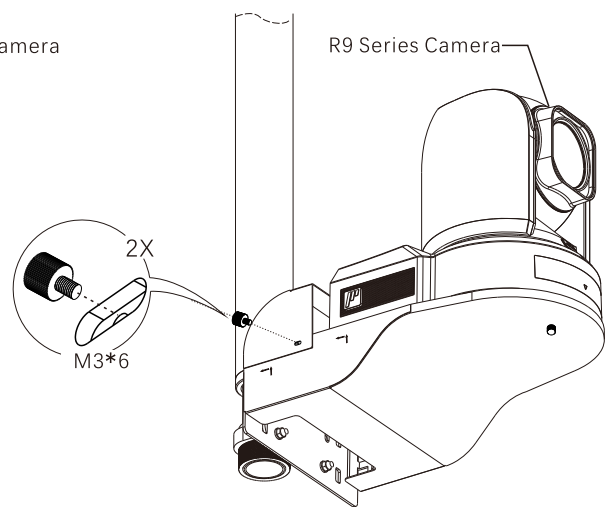
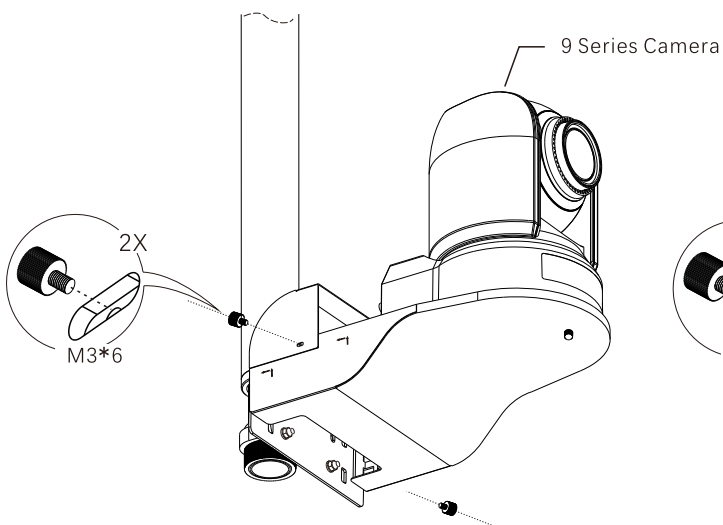
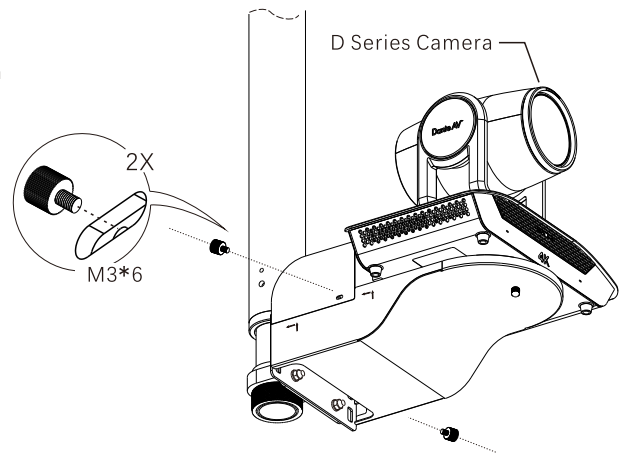
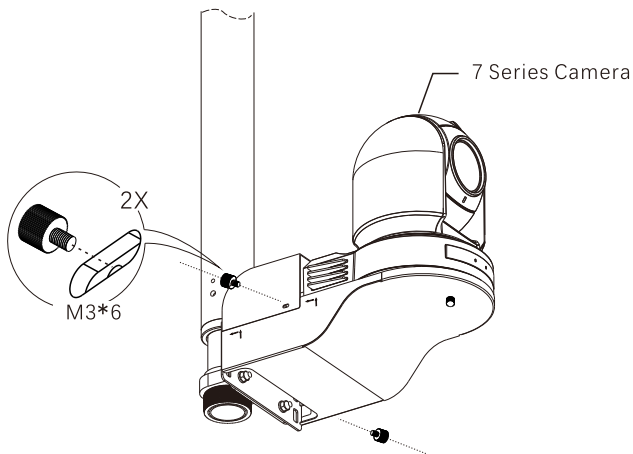

# Ceiling Bracket - Combination C

## Accessories

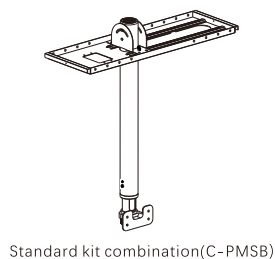

+

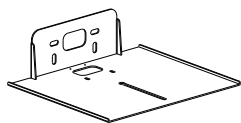

C-WPLB Pallet Bracket x1 (optional)



Fixing Screw x1  
(1/4-20UNC)



Fixing Screw x1  
(3/8)

## Bracket Exploded View

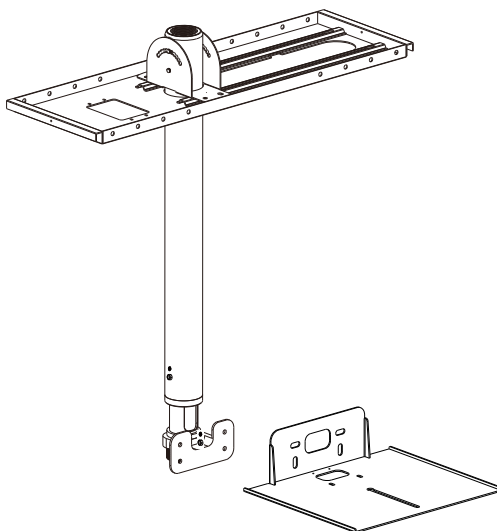

## Installation Steps

①

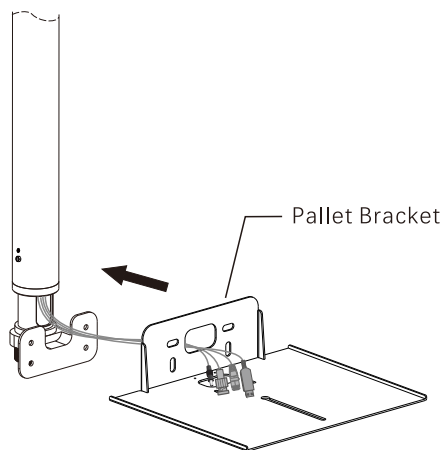

②

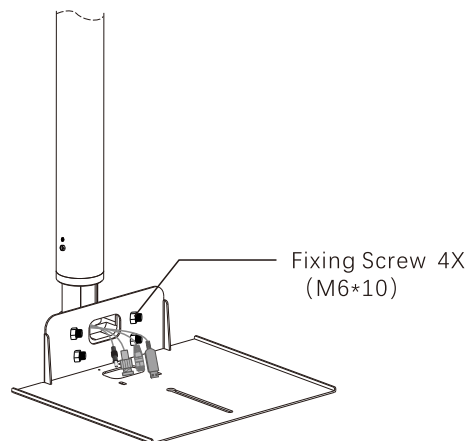

③

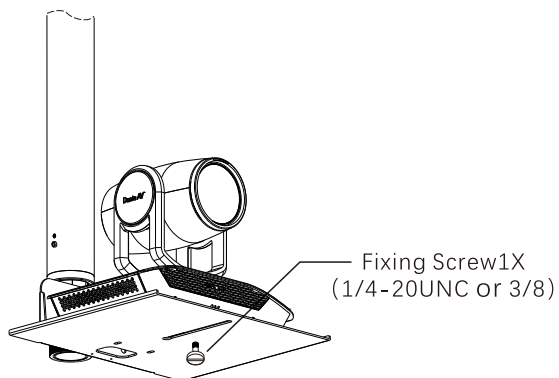

## Ceiling Bracket - combination D

### Accessories



C-PMB-HS x1

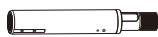

Boom x1  
(Length: 600-1000mm)



Boom Connector x1



Nut x1



Nut x1



M6\*60x3  
For fixing Boom attachments



M6\*16x4  
For fixing Boom attachments



M4\*12 x2

### Bracket Exploded View

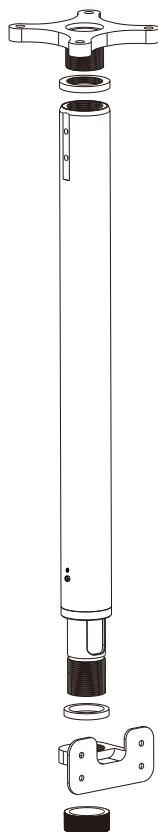

### Installation Steps

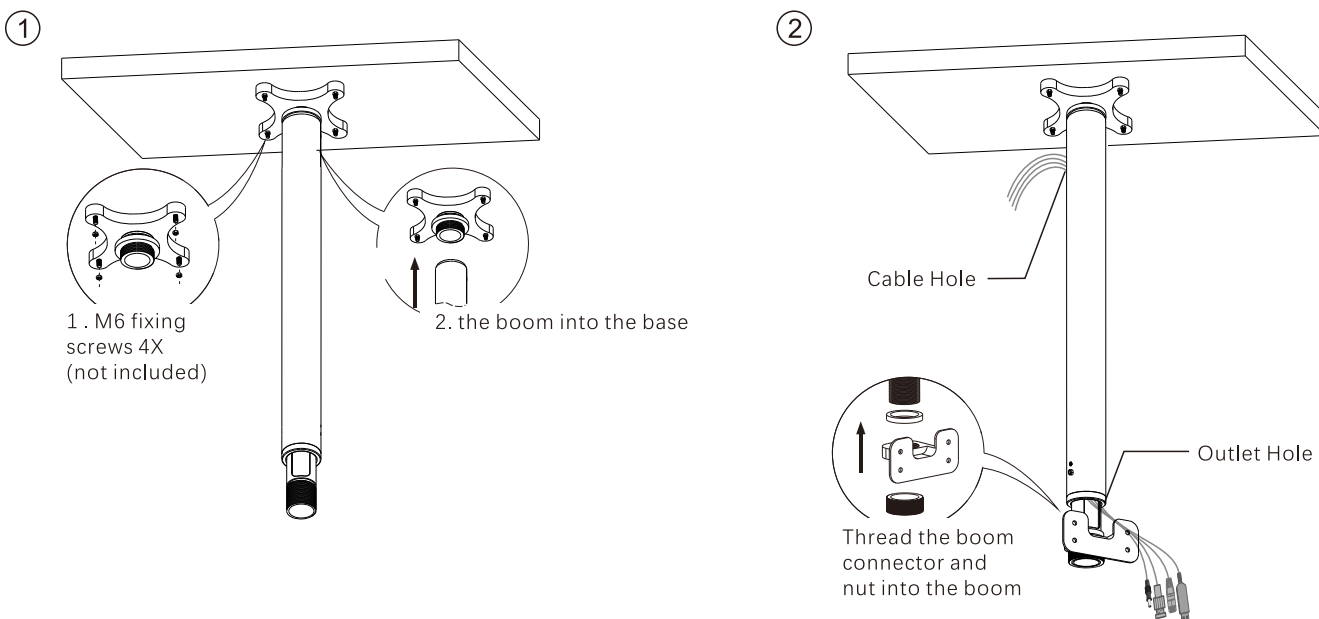

< medium brackets, large brackets and decorative covers, and has been adapted to install different cameras. For the specific installation method, please refer to the schematic diagram in the previous chapter. >

## Ceiling Bracket - combination E

### Accessories



C-PMB-HS x1

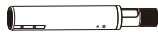

Boom x1  
(Length: 600-1000mm)



Boom Connector x1



Nut x1



Nut x1



M6\*60x3  
For fixing Boom attachments



M6\*16x4  
For fixing Boom attachments



M4\*12 x2

### Bracket Exploded View

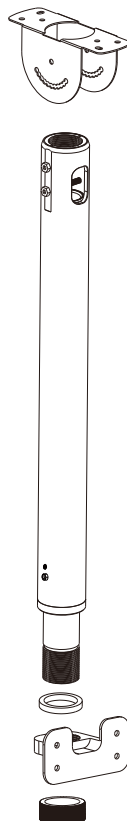

### Installation Steps

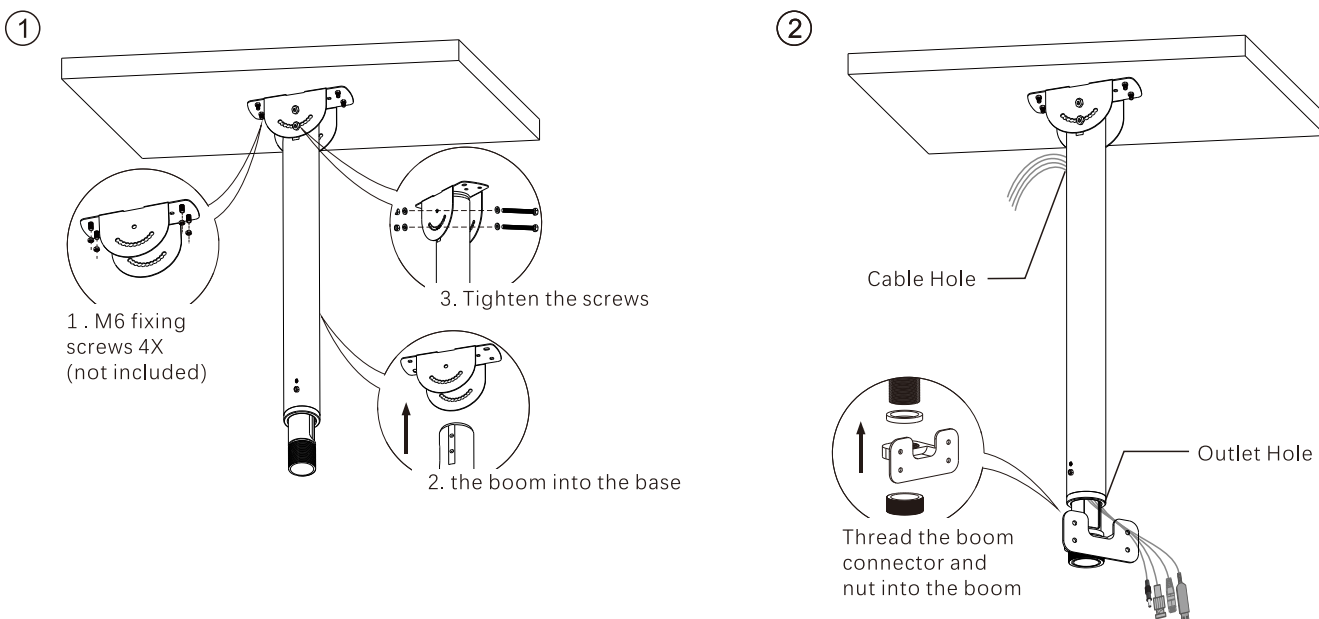

< medium brackets, large brackets and decorative covers, and has been adapted to install different cameras. For the specific installation method, please refer to the schematic diagram in the previous chapter. >