

ES-WM x1

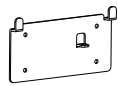

Mounting Support  
Bracket x1



Positioning Template x1



1/4-20UNC x4



Safety Cable x1

## Install ES-WM

1.

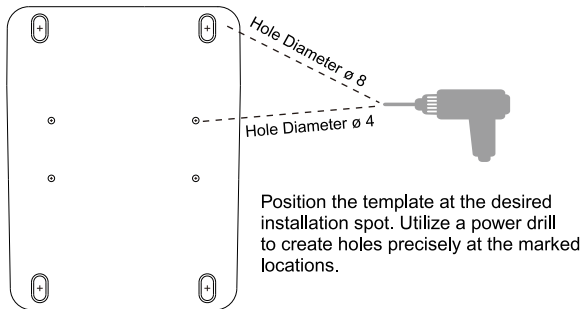

2.

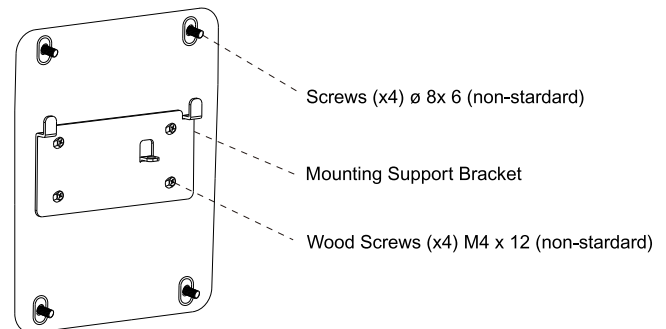

3.

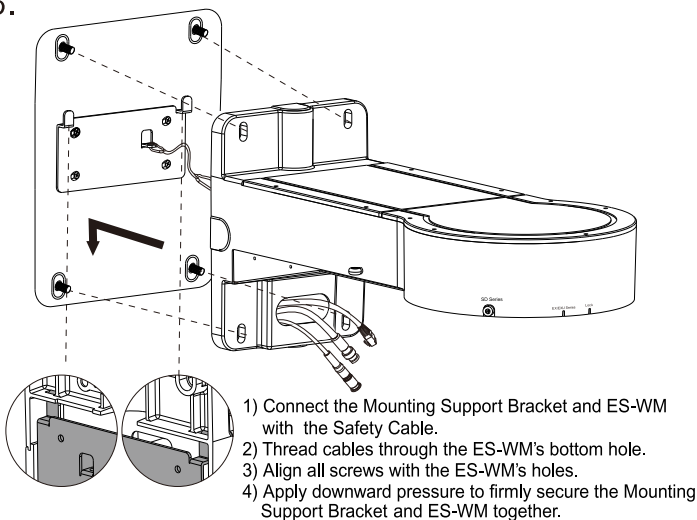

4.

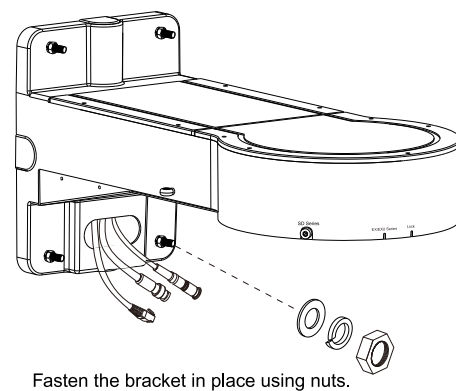

## Install EXU series on ES-WM

1.

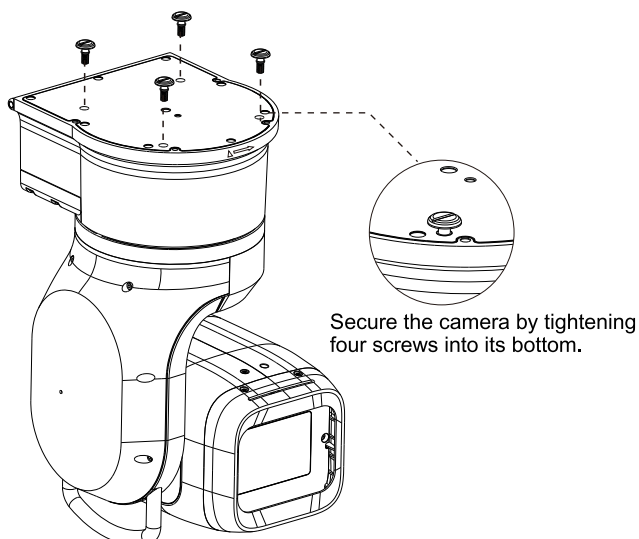

2.

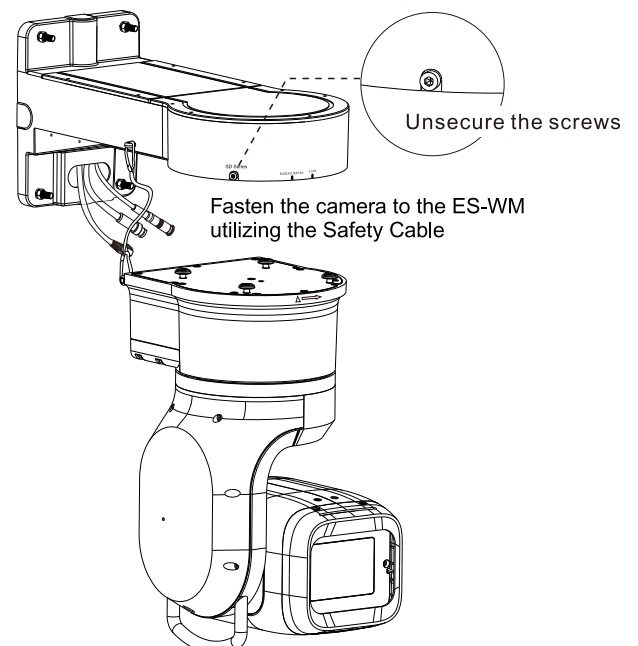

3.

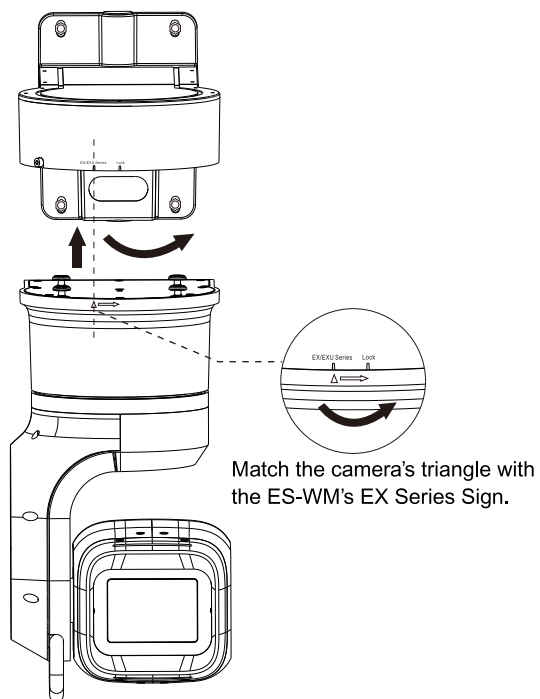

4.

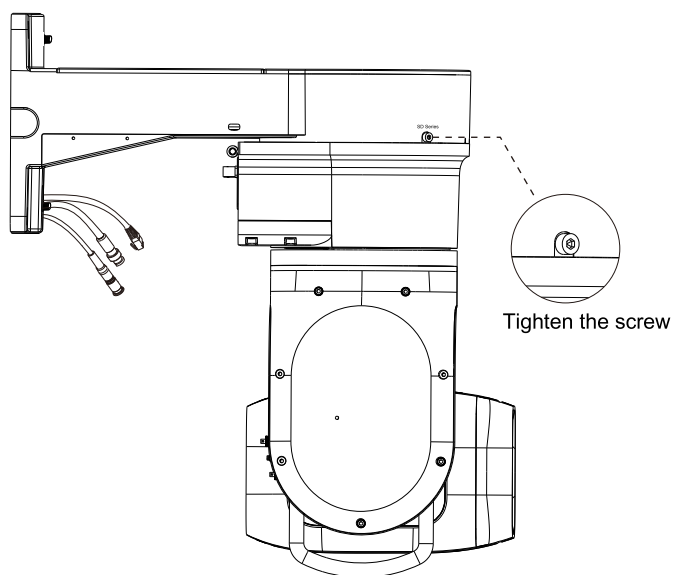

5.

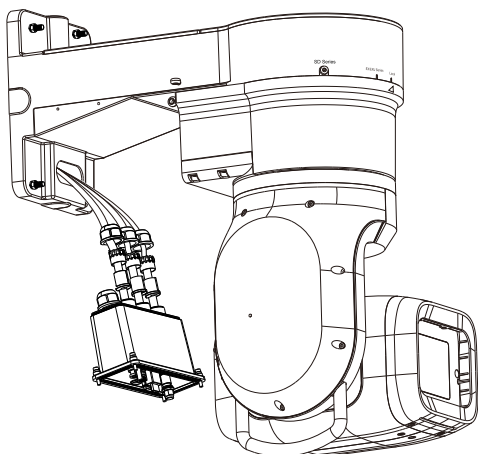

Thread the cables through the waterproof case.

6.

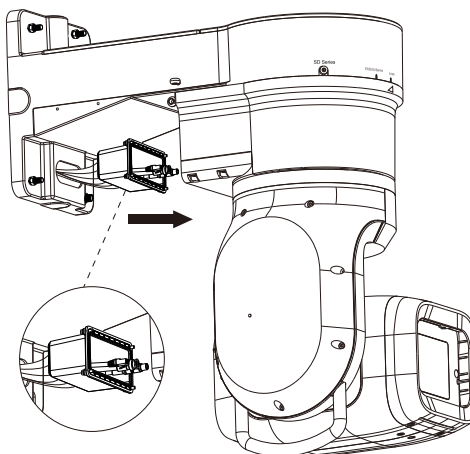

Plug cables into the camera's ports.

7.

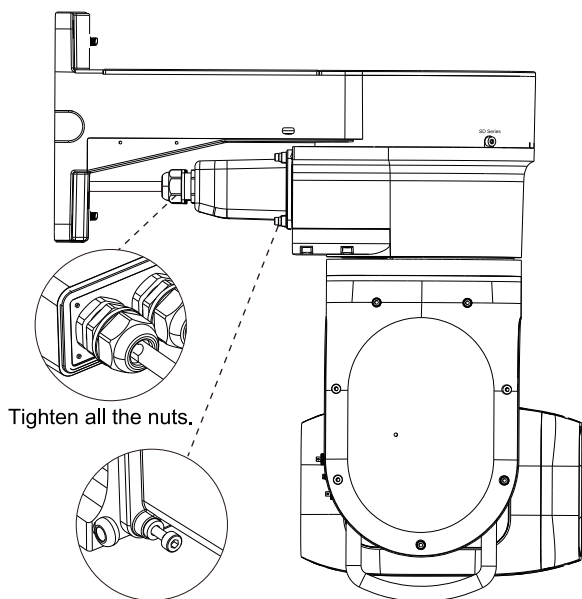

Attach the waterproof case and secure it by tightening the four screws.

8.

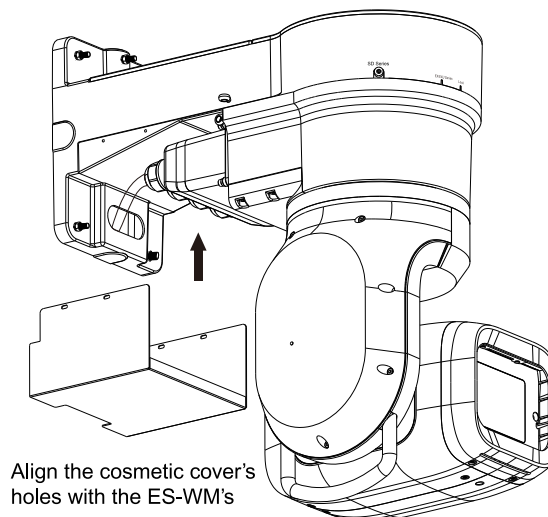

9.

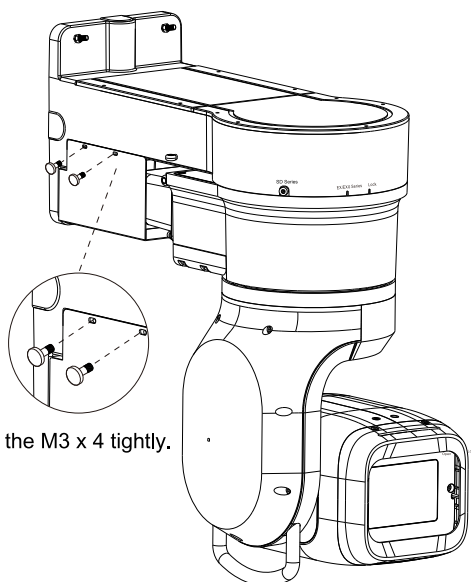

9.1

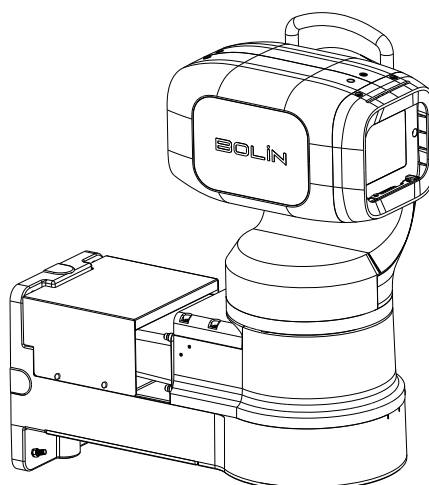

Please note: When the camera is mounted in an inverted position, the ES-WM bracket will also be oriented upside down.

## Install Ex1030 on ES-WM

1.

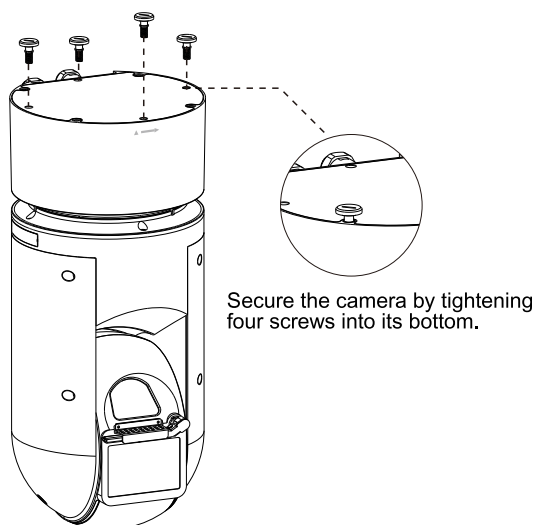

2.

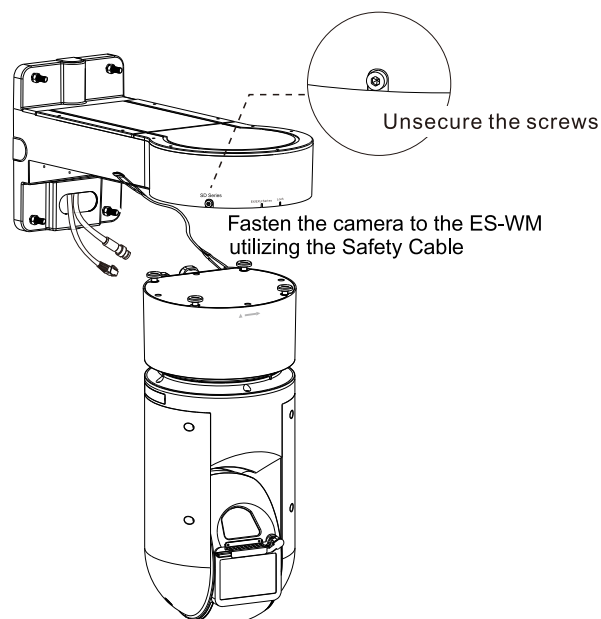

3.

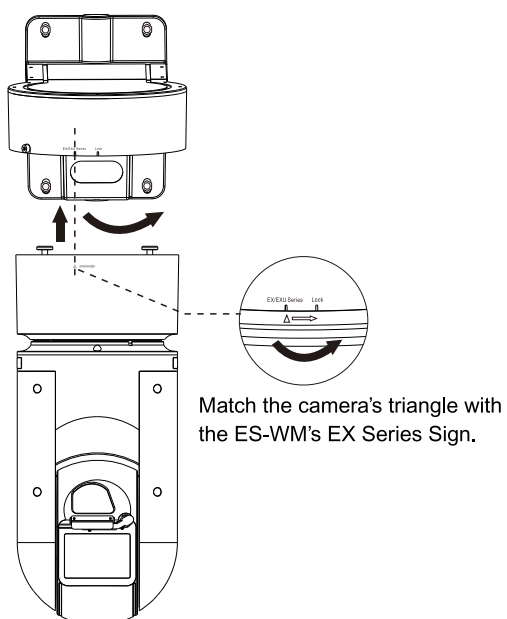

4.

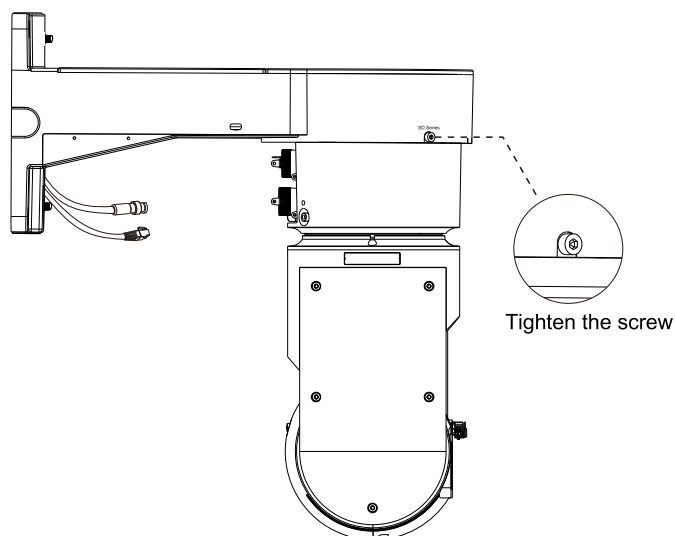

5.

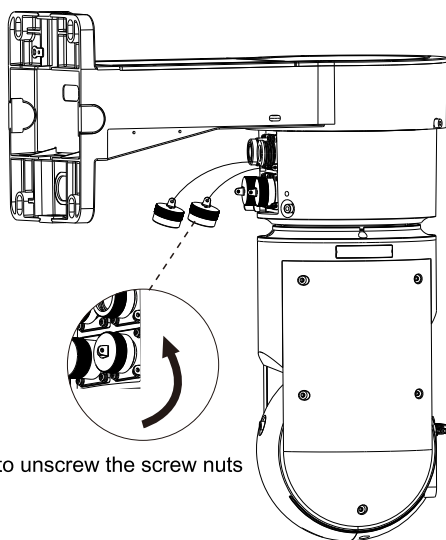

Rotate to unscrew the screw nuts

6.

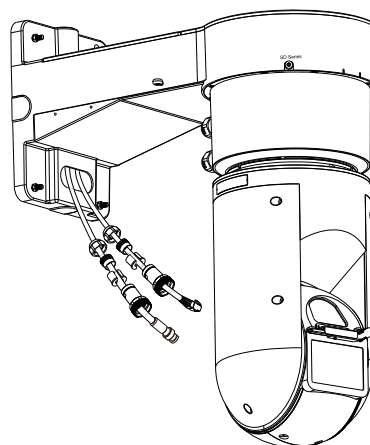

Thread the cables through the waterproof case.

7.

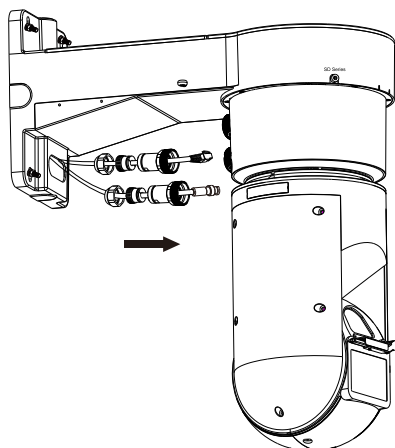

Plug cables into the camera's ports.  
and tighten the water-proof screw nuts

8.

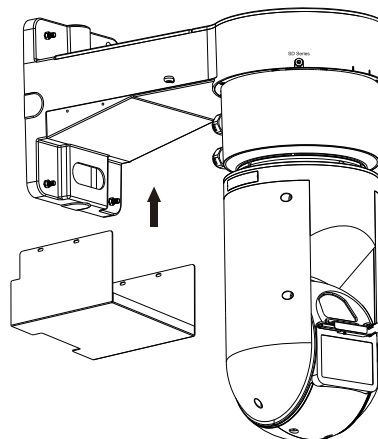

Align the cosmetic cover's  
holes with the ES-WM's

9.

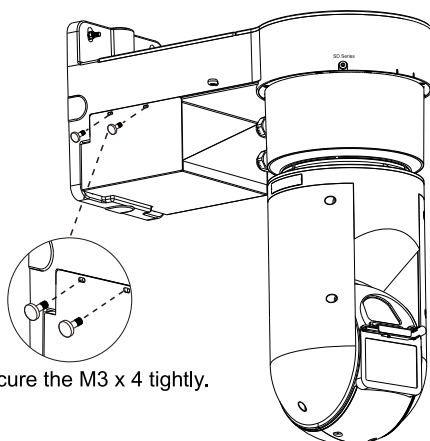

Secure the M3 x 4 tightly.

## Install SD5 series on ES-WM

1.

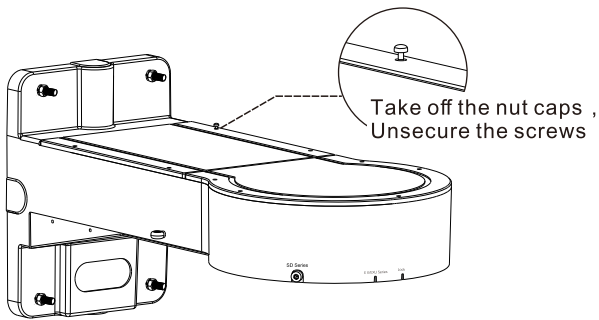

2.

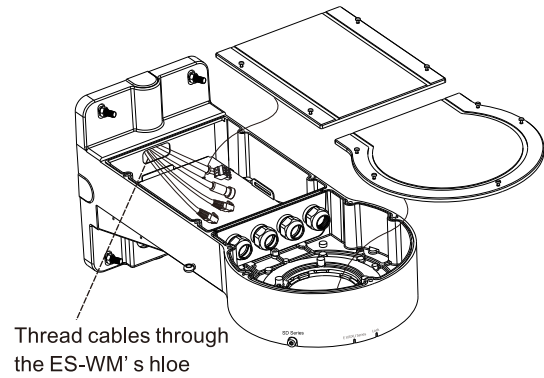

3.

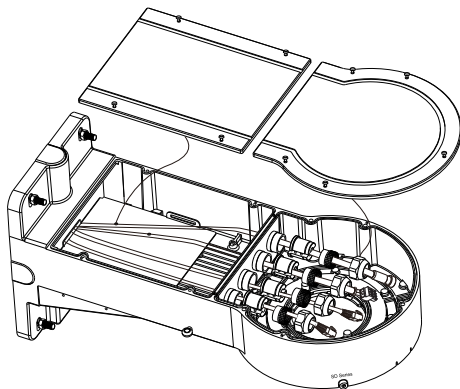

4.

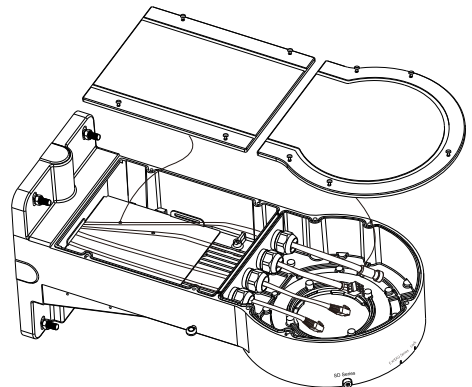

5

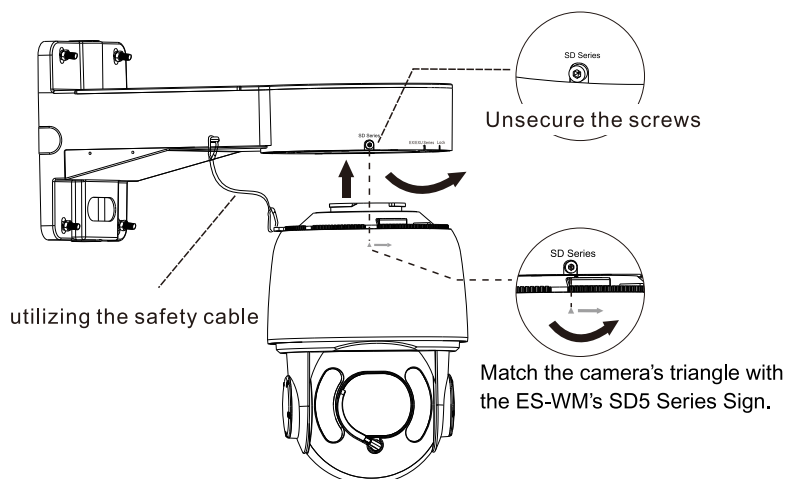

6

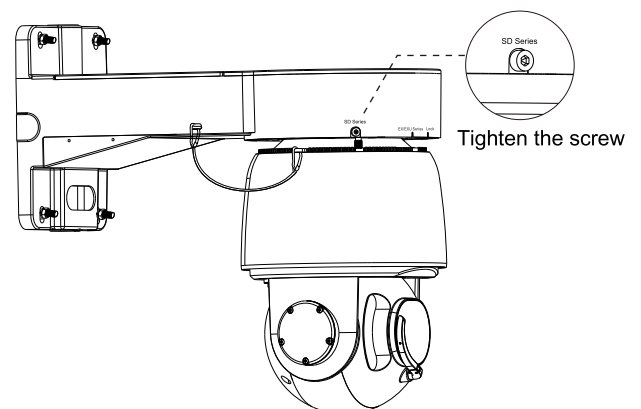

7.

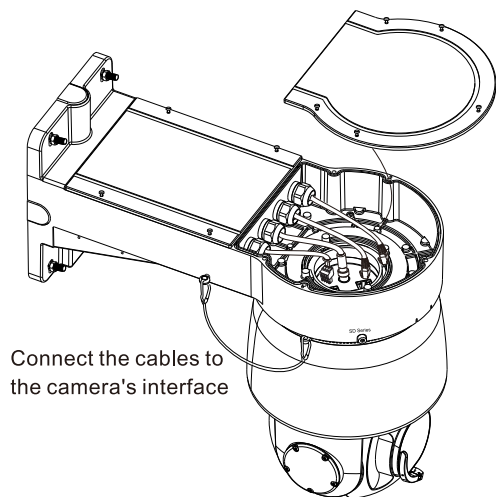

8.

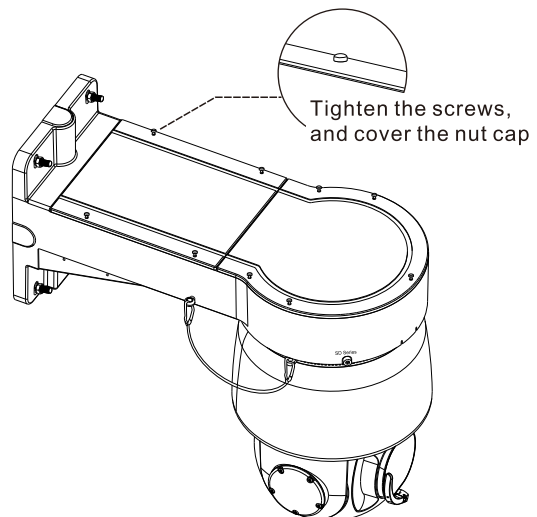

9.

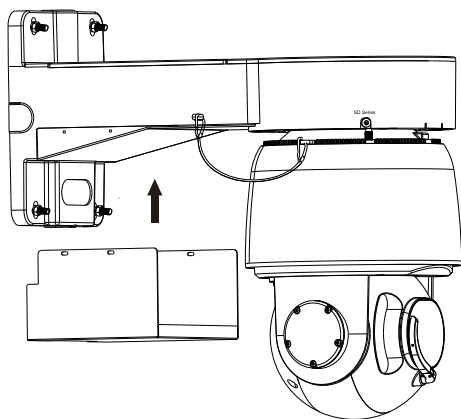

10.

